

差込継手 (ニップル)

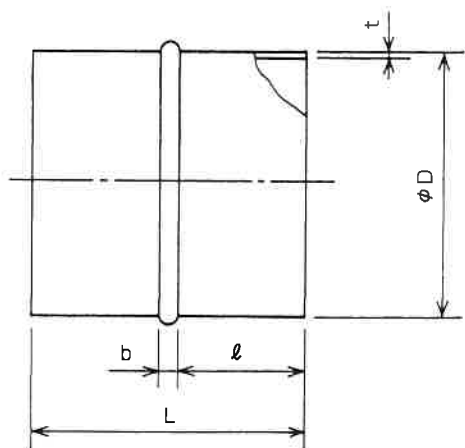

呼び径	寸 法			
ϕD	t	L	ℓ	b
75	0.6	130	60	10
100	0.6	130	60	10
125	0.6	130	60	10
150	0.6	130	60	10
175	0.6	130	60	10
200	0.6	130	60	10
225	0.6	130	60	10
250	0.6	130	60	10
275	0.6	130	60	10
300	0.6	130	60	10
325	0.6	130	60	10
350	0.6	130	60	10
375	0.6	130	60	10
400	0.6	130	60	10
425	0.8	130	60	10
450	0.8	130	60	10
475	0.8	130	60	10
500	0.8	130	60	10
525	0.8	130	60	10
550	0.8	130	60	10
575	0.8	130	60	10
600	0.8	170	80	10
650	0.8	170	80	10
700	0.8	170	80	10
750	1.0	170	80	10
800	1.0	170	80	10
850	1.0	170	80	10
900	1.0	170	80	10
950	1.0	170	80	10
1000	1.0	170	80	10

定着カラー

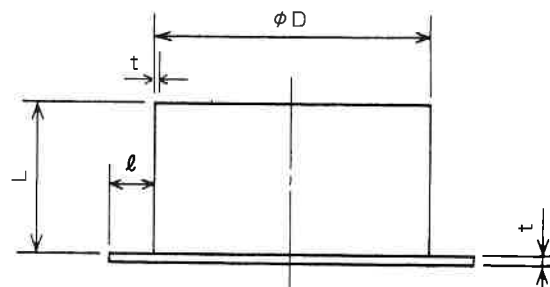

呼び径	寸 法		
ϕD	t	L	ℓ
75	0.6	60	12
100	0.6	60	12
125	0.6	60	12
150	0.6	60	12
175	0.6	60	12
200	0.6	60	12
225	0.6	60	12
250	0.6	60	12
275	0.6	60	12
300	0.6	60	12
325	0.6	60	12
350	0.6	60	12
375	0.6	60	12
400	0.6	60	12
425	0.8	60	12
450	0.8	60	12
475	0.8	60	12
500	0.8	60	12
525	0.8	60	12
550	0.8	60	12
575	0.8	60	12
600	0.8	80	12
650	0.8	80	12
700	0.8	80	12
750	1.0	80	12
800	1.0	80	12
850	1.0	80	12
900	1.0	80	12
950	1.0	80	12
1000	1.0	80	12